

VIKELA

TYRELLA

TYRELLA Body Armour

Vikela's TYRELLA range of ballistic body Armour delivers contoured lightweight protection that is designed to fit both female and male body types. Our plates can be manufactured to meet low and high level ballistic standards.

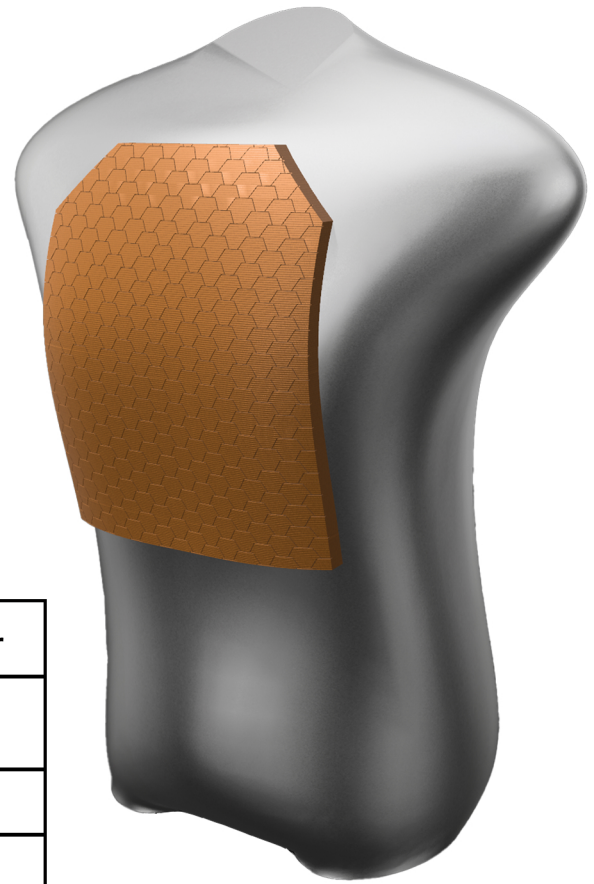

Application	TYRELLA Body Armour
Application	Stand Alone Body Armour
Testing Standard	NIJ
Protection Level	Level 3a & 4
Plate Thickness <small>(standard range NIJ level 4)</small>	18mm
Weight <small>(plate replacement size medium)</small>	1.4kg
Shapes and Sizes	Mens (S,M & L) & Womens (S,M, & L)

Technical Information

	Male		Female	
	Level 3a	Level 4	Level 3a	Level 4
Thickness (mm)	14	18	16	20
Areal Density (kg/m ²)	8.8	19.1	13.6	19.9

*weights and thickness outlined relate to printed plates and aren't inclusive of carriers or additional padding structure

TYRELLA

Ballistic Protection

Standard Range

Sizes, Weights and Part Numbers

Size	Style	Dimensions (mm)				Weight (kg)		Part Numbers
		A	B	C	D	Protection level 3a	Protection level 4	
S	Replacement Plate	300	220			0.81	1.22	V-TR/M/SP(3a/4)
M	Replacement Plate	315	240			0.93	1.40	V-TR/M/MP(3a/4)
L	Replacement Plate	340	260			1.09	1.64	V-TR/M/LP(3a/4)
S	Vital coverage	400	245			2.34	3.52	V-TV/M/SP(3a/4)
M	Vital coverage	415	260			2.72	4.10	V-TV/M/MP(3a/4)
L	Vital coverage	430	275			3.23	4.71	V-TV/M/LP(3a/4)
S	Full Cover	400	245	160	120	2.78	4.19	V-TF/M/SP(3a/4)
M	Full Cover	415	260	165	150	3.28	4.94	V-TF/M/MP(3a/4)
L	Full Cover	430	275	170	150	3.87	5.83	V-TF/M/LP(3a/4)

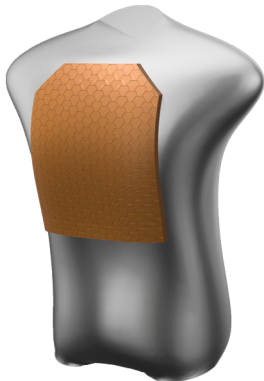
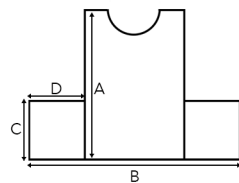
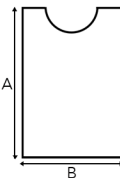
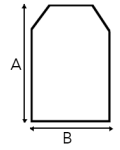

Replacement Plates



Vital coverage
(front and back)



Full cover
(front, back and sides)

Female Range

Sizes, Weights and Part Numbers

Size	Style	Cup Size	Dimensions (mm)				Weight (kg)		Part Numbers
			A	B	C	D	Protection level 3a	Protection level 4	
S1	Vital coverage	A-C	350	225			2.57	3.77	V-TV/F/S1P(3a/4)
S2	Vital coverage	D-F	370	225			3.02	4.42	V-TV/F/S2P(3a/4)
M1	Vital coverage	A-C	360	245			2.98	4.36	V-TV/F/M1P(3a/4)
M2	Vital coverage	D-F	380	245			3.46	5.07	V-TV/F/M2P(3a/4)
L1	Vital coverage	A-C	380	265			3.42	5.01	V-TV/F/L1P(3a/4)
L2	Vital coverage	D-F	400	265			3.94	5.76	V-TV/F/L2P(3a/4)
S1	Full Cover	A-C	350	225	145	110	2.90	4.25	V-TF/F/S1P(3a/4)
S2	Full Cover	D-F	370	225	145	110	3.35	4.90	V-TF/F/S2P(3a/4)
M1	Full Cover	A-C	360	245	150	130	3.38	4.94	V-TF/F/M1P(3a/4)
M2	Full Cover	D-F	380	245	150	130	3.86	5.64	V-TF/F/M2P(3a/4)
L1	Full Cover	A-C	380	265	155	150	3.89	5.69	V-TF/F/L1P(3a/4)
L2	Full Cover	D-F	400	265	155	150	4.40	6.44	V-TF/F/L2P(3a/4)

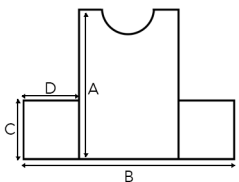
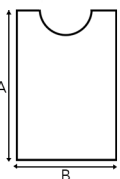

Vital Coverage
Female
(front and back)



Full Cover Female
(front, back and sides)

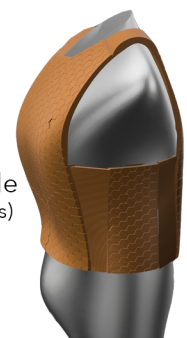

*These are our standard size ranges but we can also offer XS and XL sizes upon request.